

Nylon- Insulated Flange Female Quick Disconnects

- Maximum electrical rating: 105°C, 300V
- Insulation: Nylon
- Terminal Body: Brass
- Plating: Tin

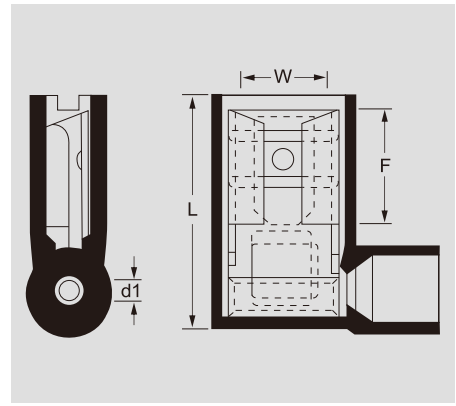

ITEM NO .	Nema Tab	DIMENSION mm					PCS/ PACK	COLOR	EXPLANATION
		W	F	L	d1	T			
FLDNY1.25-250	0.8×6.35	7.5	8.4	16	1.7	0.5	100	Red	Wire range : 0.5-1.0mm ² A. W. G : (22-18) Max.current=10A
FLDNY2-250	0.8×6.35	7.5	8.4	16	2.3	0.5	100	Blue	Wire range : 1.5-2.5mm ² A. W. G : (16-14) Max.current=15A
FLDNYD5.5-250	0.8×6.35	7.5	7.3	18	3.4	0.4	100	Yellow	Wire range : 4-6mm ² A. W. G : (12-10) Max.current=24A

Nylon- Insulated Bullet Female Quick Disconnects

- Maximum electrical rating: 105°C, 300V
- Insulation: Nylon
- Terminal Body: Brass
- Metallic Sleeve: Copper
- Plating: Tin

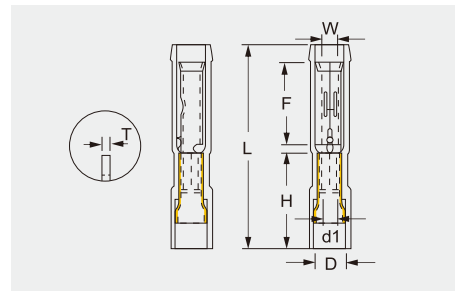

ITEM NO .	DIMENSION mm							PCS/ PACK	COLOR	EXPLANATION
	W	L	F	H	d1	D	T			
FRFNVD0.5-078	2.05	24.8	10.0	11.0	1.6	3.5	0.3	100	White	Wire range : 0.5-0.75mm ² Max.current=10A

Nylon- Insulated Bullet Male Quick Disconnects

- Maximum electrical rating: 105°C, 300V
- Insulation: Nylon
- Terminal Body: Brass
- Metallic Sleeve: Copper
- Plating: Tin

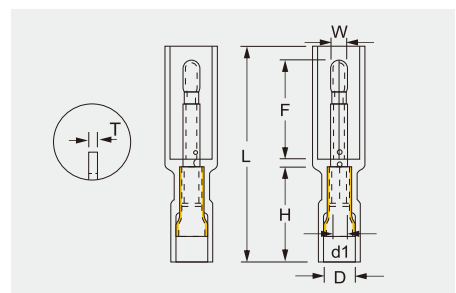

ITEM NO .	DIMENSION mm							PCS/ PACK	COLOR	EXPLANATION
	W	L	F	H	d1	D	T			
FRFNVD0.5-078	2.0	27.0	12.0	11.0	1.6	3.5	0.3	100	White	Wire range : 0.5-0.75mm ² Max.current=10A